









Smoke and Carbon Monoxide Sensor

TLL331561

-  Installation guide and operation instructions
-  Ghid de instalare și instrucțiuni de funcționare
-  Guía de instalación e instrucciones de funcionamiento
-  Guide d'installation et mode d'emploi
-  Guida all'installazione e istruzioni per l'uso
-  Einbauanleitung und Bedienungsanleitung



INTO YOUR FUTURE

Thank you for choosing Tellur!

To ensure an optimum performance and safety, please, read this user manual carefully before using the product. Keep this user manual safe for future references.

Contents

1. GENERAL SAFETY INFORMATIONS:.....	3
1.1. WARNINGS.....	3
1.2. ATTENTION.....	3
1.3. IMPORTANT NOTES ABOUT WIFI SMART CONTROL WITH TELLUR SMART APP.....	3
2. PRODUCT OVERVIEW.....	4
2.1. PRODUCT DIAGRAM.....	4
2.2. MAIN FUNCTIONS.....	5
2.3. NOTES.....	5
3. PRODUCT INSTALLATION.....	5
3.1. PREPARATIONS AND CHECKS BEFORE INSTALLATION.....	4
3.2. MOUNTING DIAGRAM.....	5
3.2.1 SENSOR PLACEMENT.....	5
3.2.2. LOCATIONS TO AVOID.....	5
3.2.3 SENSOR INSTALLATION.....	6
3.3. USING THE SENSOR.....	6
3.3.1 SENSOR TEST.....	7
3.3.2 LED AND SOUND INDICATORS.....	7
3.3.3 SILENCE MODE.....	7
3.3.4. MAINTENANCE AND CLEANING.....	7
3.3.5. TROUBLESHOOTING.....	8
4. PAIRING THE DEVICE WITH TELLUR SMART APP.....	8
4.1. ATTENTION.....	8
4.2. DOWNLOAD AND INSTALL THE TELLUR SMART APP.....	8
4.3. CREATE AN ACCOUNT.....	9
4.4. PRODUCT PAIRING WITH TELLUR SMART APP.....	9
4.5. NOTES.....	10
5. TELLUR SMART APP FEATURES.....	11
5.1. Main interface.....	11
5.2. SETTINGS.....	11
5.3. OTHERS.....	12
6. TROUBLESHOOTING.....	12
7. SPECIFICATIONS.....	14
8. WEEE, CONFORMITY, WARRANTY.....	15

1. GENERAL SAFETY INFORMATIONS:

1.1. WARNINGS

- Respect the safety measures and use proper and sturdy tools (ex: ladders, chairs) when installing the product at a bigger height from the ground.
- Make sure you have prepared the necessary tools suitable for assembly and disassembly.
- Respect the technical specifications of the product and do not use it outside the declared operating parameters.

1.2. ATTENTION

- Always use the indicated battery type, do not replace it with other battery.
- Proper dispose of the battery, do not incinerate, burn, dismantle the battery.
- Avoid mounting the device in a place where the temperature changes too much, such as a heat source, air-outlet, etc. It will cause the equipment to send false alarms.
- Don't use the product if it is damaged in any way, shape, or form.
- Don't attempt to repair, disassemble, or modify this product.
- Keep out of reach of children, especially the battery.

1.3. IMPORTANT NOTES ABOUT WIFI SMART CONTROL WITH TELLUR SMART APP

- Make sure you have an active 2.4GHz Wi-Fi internet network, and you have access to Wi-Fi password.
- This device is compatible with 2.4GHz Wi-Fi networks only. 5GHz Wi-Fi is not supported. If you don't have 2.4GHz Wi-Fi network available, check the router settings, contact a specialized technician or the internet provider for support.
- The app does not support Wi-Fi 6 networks with 802.11ax standard. Please set the 2.4GHz Wi-Fi network to 802.11b/g/n.
- No special gateway is required to remotely control the product via Wi-Fi.
- Wi-Fi passwords should not include special characters such as: ~! @#\$%^&*().
- Make sure your Wi-Fi internet is stable and the signal is strong enough in the installation location.

2. PRODUCT OVERVIEW

2.1. PRODUCT DIAGRAM

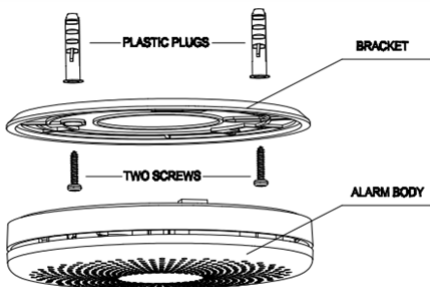
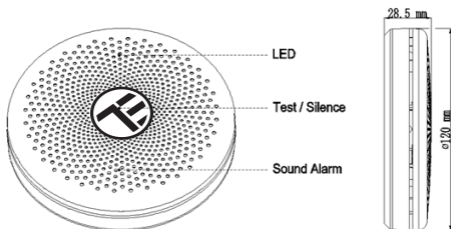

2.2. MAIN FUNCTIONS

- Detects smoke & carbon monoxide change and triggers the alarm.
- Multiple types of alarms: light indicator, high-decibel acoustic alarm & push notification.
- 85 dB loud alarm so you can hear from a distance.
- Easy to install and use, large test/silence button.
- Automatic calibration, low battery warning.
- Integrated in Tellur Smart APP, compatible with voice assistants.
- History record.
- Working on the 802.11b/g/n 2.4GHz wireless network (no hub required).
- Works with 2 x 1.5V AA batteries with low energy consumption.

2.3. NOTES

For full technical specifications please check Chapter 7.

3. PRODUCT INSTALLATION

3.1. PREPARATIONS AND CHECKS BEFORE INSTALLATION

- Respect the safety measures and use proper and sturdy tools (ex: ladders, chairs) when installing the product at a bigger height from the ground.
- Respect the technical specifications of the product and do not use it outside the declared operating parameters.

3.2. MOUNTING DIAGRAM

3.2.1 SENSOR PLACEMENT

- The product is only for indoor ceiling or wall installation.
- It is recommended to install this product in each bedroom and outside the corridor. If more rooms face different corridors, it is recommended to install the product in each corridor.
- Install an alarm above the stairway and on every floor of the house.
- Smoke, heat and burning things will spread horizontally after rising to the ceiling, so install the alarm in middle of the ceiling.
- For the room or corridor that is longer than 12m, it is recommended to install one product at each end.
- If the alarm cannot be installed in the middle of the ceiling, install it to keep it 300mm away from the corners.
- If the alarm is installed on the wall, it should be 100mm away from the ceiling.
- When the wall or ceiling is slanting, the alarm needs to be installed a minimum of 500mm away from the highest wall or ceiling point in the room.

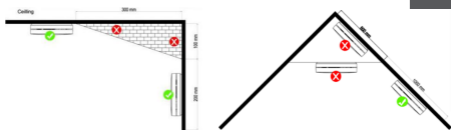

3.2.2. LOCATIONS TO AVOID

- Do not install it in the bathroom, or in places accessible to water or water droplets.
- Do not install in an area with temperature below 0-C or above 40-C.
- Do not install in very ventilated areas, such as near air conditioners, ceiling fans, or fresh air vent.
- Do not install in the place where burning particles are generated during combustion, such as the kitchen, near the stove or the exhaust gas from the garage.
- Places with difficult access, making it difficult to operate the test function.
- Next to doors or windows.
- In the top of rooms with sloping roofs, the corner of the room or other dead-air spaces.

3.2.3 SENSOR INSTALLATION

- Twist off the mounting bracket from the alarm.
- Put the bracket on the installation position and mark the screw holes on the ceiling or the wall.
- Drill two mounting holes in the mark places using an electric drill (The diameter of the drill hole is 5mm) and insert two plastic anchor plugs.
- Screw the mounting bracket to the ceiling or the wall.
- Attach the alarm to the mounting bracket and turn clockwise to lock the alarm.

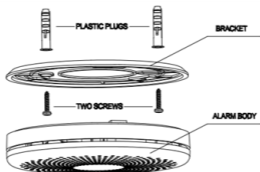

3.3. USING THE SENSOR

3.3.1 SENSOR TEST

- Test the sensor by pressing the main button. If the sensor is making a prompt sound, the unit is working properly.
- If there is no sound when pressing the button, please refer to the troubleshooting section for a solution.
- **WARNING** - Do not test the sensor with an open flame to avoid damaging the product.
- **WARNING** - Do not stand too close to the sensor when the alarm is sounding. Exposure at close range may be harmful. Step away when testing.

3.3.2 LED AND SOUND INDICATORS

- Normal status: GREEN LED flashes once every 60 seconds.
- Test status: Two sets of 3 long beeps with RED LED flashes and two sets of 4 quick beeps with RED LED flashes.
- Smoke alarm: RED LED flashes 4 times synchronized with 4 long beeps.
- Carbon monoxide alarm: RED LED flashes 3 times synchronized with 3 short beeps.
- Hush/Silence mode: RED LED flashes once every 8 seconds.
- Low Battery status: RED LED flashes once every 60 seconds and 1 beep every 60 seconds.
- Fault status: The alarm will beep every 40 seconds.

3.3.3 SILENCE MODE

- While the unit is alarming, you can push the test button. The alarm will be paused for 10 minutes. The RED LED will flash once every 8 seconds, it indicates the smoke alarm device is running into silence mode. The silence feature is to be used only when a known alarm condition, such as smoke from cooking activates the alarm. The smoke alarm device will automatically reset after 10 minutes, if after this period, particles of combustion are still present, the alarm will sound again.
- **WARNING** - Before using the alarm silence, identify the source of the smoke and be certain a safe condition exists.

3.3.4. MAINTENANCE AND CLEANING

- Test the alarm each week to ensure proper protection.
- If need cleaning, use a soft brush or cloth.
- Do not paint the sensor. Paint will seal the vents and interfere with the sensor's ability to detect smoke.

- Never attempt to disassemble the alarm to clean inside.
- The low battery signal can last for max. 30 days, please replace the batteries in time to keep it working properly.
- Make sure to correctly install the batteries on negative and positive poles.

3.3.5. TROUBLESHOOTING

Issue	Solution
The alarm does not sound when testing	Check if the batteries are in good condition and are correctly installed.
Red LED flashes and the alarm delivers one beep every 60 seconds	The batteries level is low. Replace the batteries as soon as possible.
The alarm delivers one beep every 40 seconds	Clean the alarm. Please refer to the "maintenance and cleaning" section. The sensor is malfunctioning. Contact the retailer to replace it.
False alarms triggered intermittently or when residents are cooking, taking showers, etc.	Press silence button.
	Clean the sensor. Please refer to the "maintenance and cleaning" section.
	Re-position the sensor if there are many false alarms.

4. PAIRING THE DEVICE WITH TELLUR SMART APP

4.1. ATTENTION

- This device only supports a 2.4GHz frequency band router, does not support a 5GHz frequency band router.
- Make sure your phone is connected to the 2.4GHz wireless network and you have access to Wi-Fi password before you start the pairing procedure.
- The app doesn't support Wi-Fi 6 networks with 802.11ax standard. Please set the 2.4GHz Wi-Fi network to 802.11b/g/n
- Wi-Fi passwords should not include special characters such as ~!@#\$%^&*().
- We also recommend having the Bluetooth function activated for easier pairing.
- Make sure the Wi-Fi signal is strong enough in the area where the device will be installed.

4.2. DOWNLOAD AND INSTALL THE TELLUR SMART APP

Available for either iOS or Android devices.



4.3. CREATE AN ACCOUNT

Once downloaded, the app will ask you to create an account (if you don't have one already). Enter your email, select the country you live in and create a password for your Tellur Smart account.

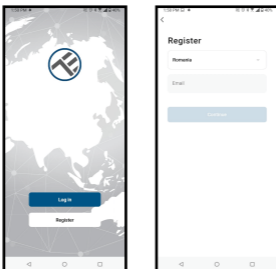

4.4. PRODUCT PAIRING WITH TELLUR SMART APP

- Option 1 Bluetooth – Recommended.
 - o We recommend having the Bluetooth function of the smartphone activated for easier pairing.
 - o Click on the + sign in upper right corner and select Add device.
 - o A pop-up will appear if the device is ready to be paired.

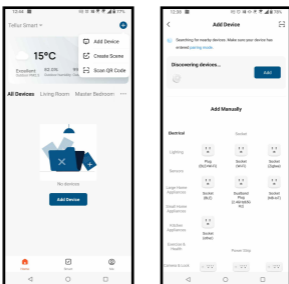

- Option 2 Manual add.
 - o Open the Tellur Smart app and click “Add device” or “+” and then select “Sensors” -> “Smoke Detector (Wi-Fi)”.
- Power on the sensor and quickly press the button 4 times until the LED is flashing.
- Select the Wi-Fi network, input your Wi-Fi password and click “Next”.
- Wait for the device to be added automatically. Tap “Done” when finished and the device will appear in your list.



4.5. NOTES

- 10** For Troubleshooting please check Chapter 6.

5. TELLUR SMART APP FEATURES

5.1. Main interface

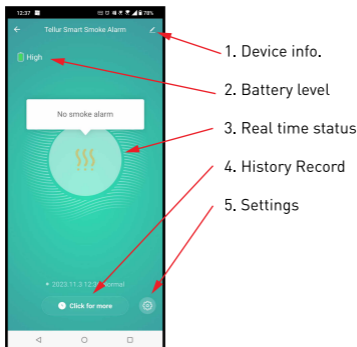

5.2 SETTINGS

- You can select the notifications that you want to receive when the device status has changed.
- You can check if the auto testing has been done successfully.

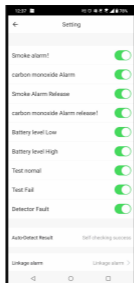

5.3 OTHERS

- Smart - Create various automations and scenarios using weather changes, other devices behavior or schedules.

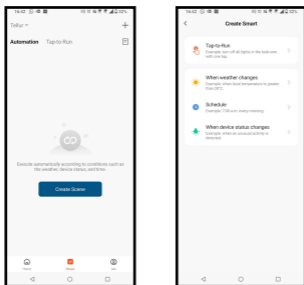

6. TROUBLESHOOTING

- Check the Wi-Fi connection of your phone.
- Check if the device is in pairing mode. Reset your smart device to enter pairing mode.
- Check router or related: If you use a dual-band router, select the 2.4GHz network to add the device. You also need to enable the router's broadcasting function. Set encryption method as WPA2-PSK and authorization type as AES or set both on "auto".
- Check if the Wi-Fi signal is strong enough. To maintain the signal strong, keep your router and the smart device as close as possible.
- Wireless mode should be 802.11.b/g/n (Wi-Fi 6 protocol 802.11ax is not supported)
- Make sure you don't exceed the maximum number of registered devices supported by the app (150).
- Check if the router's MAC filtering function is enabled. If so, remove the device from the filter list and make sure the router is not prohibiting the device connection.
- Make sure the Wi-Fi password entered in the app is correct.

Can I control the device with 3G/4G/5G network?

When adding the device for the first time, the device and the phone need to be connected to the same Wi-Fi network. Once the device has been successfully paired with the Tellur Smart app, you can remotely control it via 3G/4G/5G networks.

How can I share my device with my family?

Open Tellur Smart app, go to "Profile" -> "Device sharing" -> "Sharing sent", tap "Add sharing" and share the device with the added family members.

Notice - users must install the Tellur Smart app on their device to see shared devices.

How can I manage the devices shared by others?

Open App, go to "Profile" > "Device Sharing" > "Sharing Received", then you can find the devices shared by other users. To delete a shared device, swipe left.

7. TECHNICAL SPECIFICATIONS

EN

Power supply:	2x1.5V AA Alkaline Batteries, replaceable
Battery life:	Up to 3 years
Detection range:	Up to 50m ²
Alarm sound level:	85dB @ 3 meters
Sensor type:	Infrared Photoelectric
Smoke alarm sensitivity:	0.09 - 0.17 dB/m
CO alarm sensitivity:	50ppm - 60-90min 100ppm - 10-40min 300ppm - <3min
Mute period:	10 minutes
Push notifications:	Yes
History record:	Yes
Self-test:	Yes
Low battery notifications:	Yes, 2.6 ± 0.1 V
Smart App name:	Tellur Smart
Compatibility	Devices with Android 4.1 / iOS 8 or higher
Power consumption:	<15uA (standby); <70uA (alarm)
WiFi standard:	IEEE 802.11b/g/n
Supported WiFi network:	2,4GHz
Working condition temperature:	0°C - 40°C
Working condition humidity:	10% - 95% RH
Housing material:	ABS
Product dimensions:	Φ120 x 31mm
Product weight:	150g
Color:	White
Package includes:	1 x Smart Wi-Fi Smoke and CO Sensor 1 x Screws kit 1 x User manual
Package dimensions:	12,5 x 12,5 x 3cm
Package weight:	150g
Product code:	TLL331561
EAN:	5949120005197

Disposal and recycling information



The crossed-out wheeled-bin symbol on your product, battery, literature or packaging reminds you that all electronic products and batteries must be taken to separate waste collection points at the end of their working lives; they must not be disposed of in the normal waste stream with household garbage. It is the responsibility of the user to dispose of the equipment using a designated collection point or service for separate recycling of electrical and electronic equipment waste (WEEE) and batteries according to local laws. Proper collection and recycling of your equipment helps ensure EEE waste is recycled in a manner that conserves valuable materials and protects human health and the environment. Improper handling, accidental breakage, damage, and/or improper recycling at the end of its life may be harmful for health and environment.

Declaration of conformity

We, ABN SYSTEMS INTERNATIONAL S.A, Bucharest, Sector 1, Marinariilor street, nr. 31, declare on own responsibility that the product below:

Product description	Brand	Product code
Tellur Smart WiFi Smoke and CO Sensor, AA, white	Tellur	TLL331561

Does not endanger life, health, work safety, does not have a negative impact on the environment and corresponds to the standards stated in the manufacturer's declaration of conformity.

The product is compliant with the following standards and / or other normative documents:

RED 2014/53EU:

Article 3.1(a) – Health: EN IEC 62311:2020

Article 3.1(a) – Safety: EN 62368-1: 2020+A11:2020

Article 3.1(b) – EMC: EN 301 489-1 V2.2.3(2019-11), EN 301 489-17 V3.2.4 (2020-09)

Article 3.2 – Spectrum: EN 300 328 V2.2.2(2019-07)

ROHS - 2011/65/EU

IEC62321-1:2013

EN14604:2005/AC:2008 (for smoke detector)

EN50291:2010 (for carbon monoxide detector)

The product bears CE mark, applied in 2023.

Name: George Barbu
Function: General manager

Place and date: Bucharest, 24.10.2023
Signed:

