

#IntoYourFuture



TELLUR

#FollowTellur

WiFi Wall Plug

- ☐ Remote control
- ☐ Voice control
- ☐ Powerful



Smart Energy

Simple, but yet smart!
The WiFi Wall Plug can be easily
installed and used with the
Tellur Smart app.



The device can be easily
controlled by simply using voice

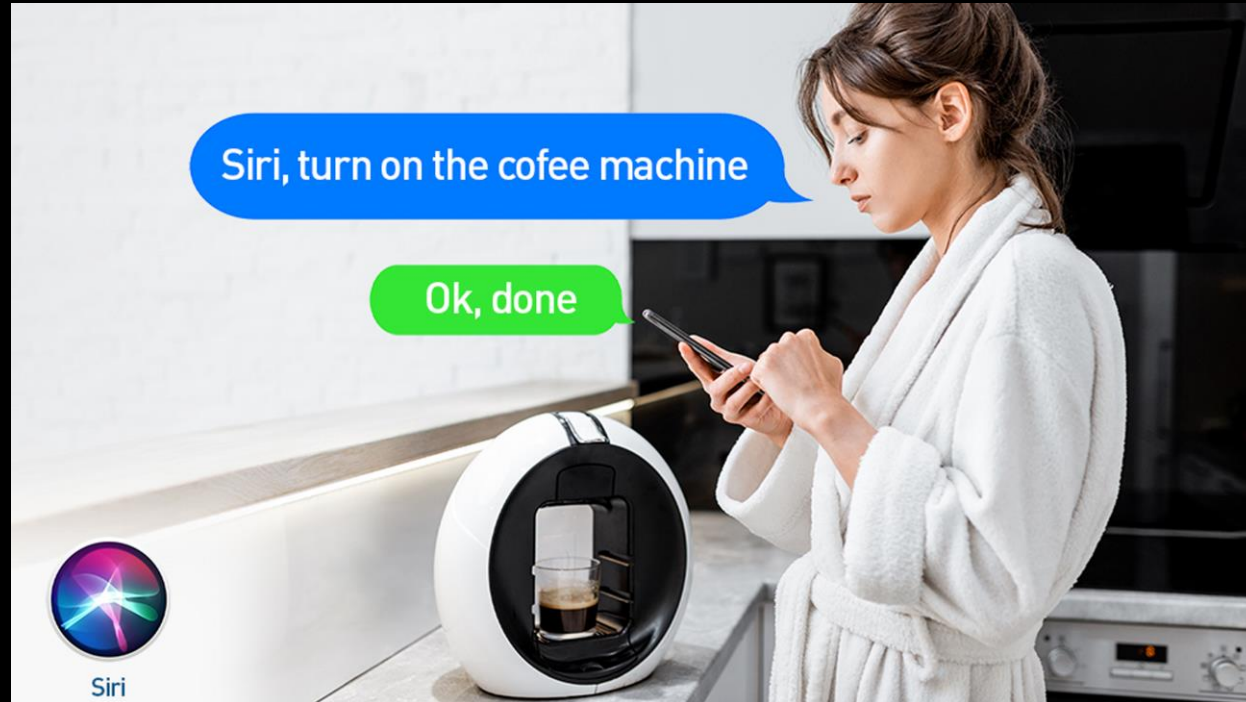
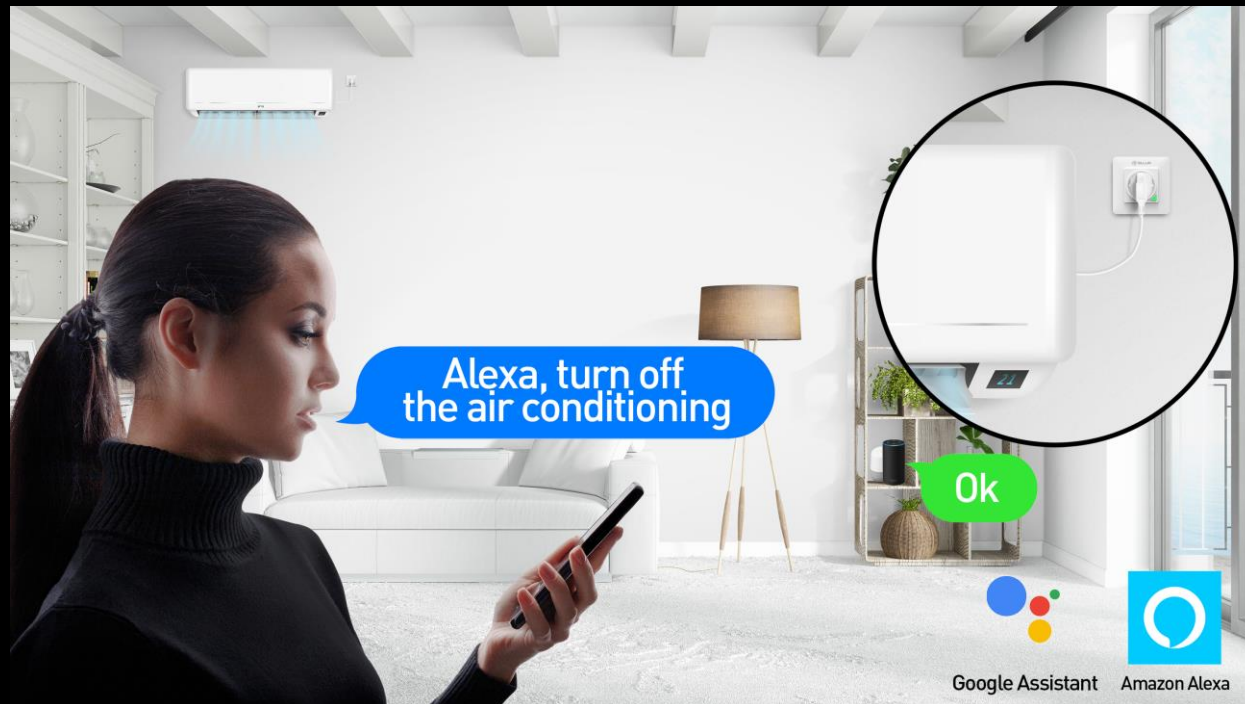

Automatization and Smart scenario

Use all the integrated smart functions the plug being fully customizable using only your smartphone.

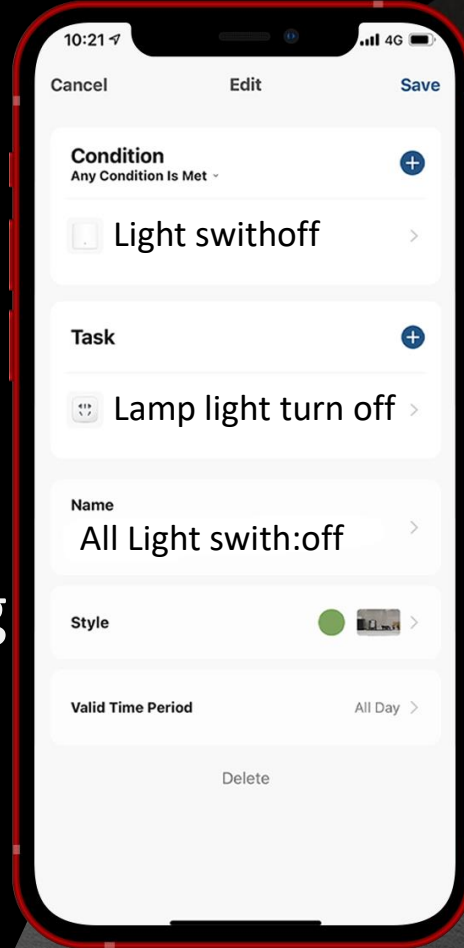

Time Settings

Set timers and schedules



Remote Control

Moreover, it can be remotely controlled anytime, from anywhere through the Tellur Smart app.



Safety

Thanks to its integrated overload protection function, it keeps devices safe by switching off the power supply when a connected electrical device is overloaded in order to protect it.



Technical specs	
Outlet type:	Schuko
Voltage:	AC 100-230V
Maximum load:	16A
Max power:	3000W
Grounding:	Yes
Overload protection:	Yes
Amazon Alexa:	Yes, compatible
Google Assistant:	Yes, compatible
Wireless frequency:	2.4GHz
WiFi standard:	IEEE 802.11b/g/n
Security:	WPA-PSK/ WPA2-PSK /WPA/WPA2/WEP/WPS2/WAPI
Encryption type:	WEP/TKIP/AES
Standby consumption:	0.6W
Compatibility:	Devices with Android 4.2 / iOS 8 or more recently
Working temperature:	-15~80° C
Working Humidity:	≤80%
Package includes:	WiFi Wall Plug User Manual
Product dimensions:	86 x 86 x 43.5mm
Product weight:	130 gr
Package dimensions:	105 x 95 x 55mm
Package weight:	157 gr
Product code:	TLL331321
EAN:	5949120003520



THANK YOU!

For more information, please visit
smart.tellur.com.

